



WA-Nr.: 02.11.151/2018-09



REBOTEC® Rehabilitationsmittel GmbH
DE-49610 Quakenbrück, Artlandstr. 57-59
Telephone : (+49) 5431/9416-0
Telefax : (+49) 5431/9416-66
<http://www.rebotec.de>
e-mail: info@rebotec.de

Maintenance Instructions



Multifunctional wheel chairs



Phoenix PU/PS



Phoenix PU/PS-Hydraulic



Phoenix PU/PS-Electric

Important advisory!

Store the maintenance inspection reports carefully. This will allow you to keep an overview of the product's maintenance status.



Maintenance of chairs

1.1 Maintenance / inspection requirements

In this maintenance instructions pamphlet you'll find information and advisories on the safe and professional maintenance and/or repair work on the Multifunctional wheel chairs.

The products are **Class I** medical products as to the **93/42/EEC** and the German **MPG/Medical Products Act**.

As to the requirements of the German **MPBetreibV** Medical Products Ordinance, the products must be maintained and the hygiene requirements must be adhered to. Check your local requirements.

The product's lifetime is in large part affected by how it is used. The frequency of use and manner of use reduces the lifetime as does improper handling and inadequate maintenance.

In order to ensure safe use, a visual inspection and function check must be done at least once per year. Shorter time intervals between maintenance may be necessary when the frequency of use or the condition of the product exists due to safety reasons.

The operator has to carry out the maintenance on his own or must instruct a competent person (specialized supplier, medical supply store or a medical-maintenance-service) if he has not the needed expertise.

The products with electric or hydraulic components must be checked by a person with the corresponding expertise.

Inspection results must be documented and be confirmed by a signature. The product must be provided with an inspection sticker that states the next inspection. The product operator is responsible for assuring regularly-conducted inspections.

1.2 Maintenance scope

The product's inspection extends from the general condition to the individual components, function and safety.

Necessary repair works must be done without delay. If an immediate repair work is not possible, then it is in the patient's interest and health to put the product out of service.

1.3 Maintenance advisories

When making repairs, use only original spare parts from REBOTEC.

Do not undertake any modifications or conversions to the product on your own. These will adversely impact the product's safety and function. REBOTEC accepts no liability in such cases.

When performing maintenance and repairs, please use the product's User Instructions booklet as an aid and follow the instructions concerning proper use, re-use, lifetime, guarantee, care and maintenance.

After completing maintenance or repair work on the product, follow the requirements for hygiene for re-use.

Important hints!

- **Do not open the housing of the electric components.**
- **Check the hydraulic unit for tightness.**
- **In case of damage replace the whole hydraulic unit.**

1.4 Maintenance reports and overview

In the appendix you will find a form for documenting maintenance. You can make copies of the form. This allows you to keep an overview of the product's maintenance status.



Maintenance protocol (single report)

It is a form for proof of a single maintenance session.

Maintenance overview (total report)

It is a form for proof of executed maintenance sessions.

1.5 Disposal

For disposing of the product, follow all the advisories in the product's User Instructions booklet. Disposal must be done at a recycling company. Contact your local recycling company for more information.

1.6 Transport and storage

When transporting or storing the mobility aid for extended time periods, the **emergency OFF button** on the control unit must be **pressed in completely**.

Advisory on other documents

At our www.rebotec.de website you can download the User Instructions booklets, forms and other information.

Maintenance protocol No.: _____



Product information/Multifunctional wheel chair: Phoenix -H/-E (medical product class I) REB02.11.151-18-09

Product			
Serial no.	Year of	Use starting	
Manufacturer	User		
Location of use	Inventory no.		
Control unit	Battery no.		
Drive unit no.	Hand switch no.		

Function inspection (electric checked for: _____)

P	Article	Scope of work	Remarks	Finding*
All Phoenix-models				
1.	visual inspection	General damages		
2.	wheels	Abrasion, check brake function		
3.	armrests	Function (locking)		
4.	frame	Stability		
5.	footrests	Function, stability		
6.	backrest	Function, stability		
7.	locking brakes	Function, stability		
8.	back cushion	Damage, wear		
9.	seat-/leg cushion	Function, wear		
10.	headrest	Function, wear		
11.	tilt adjustment**	Function, wear		
12.	warning labels	Damage, absence		
13.	fasteners	All screw connections		
Additional maintenance and testing for Phoenix-models: PU-H und PS-H				
A.	Hydraulic	Lift function, tightness		
B.	foot pedal	Function raise / lower		
Additional maintenance and testing for Phoenix-models: PU-E und PS-E				
A.	drive motor	Check mech. /electrical.		
B.	stop up / down	Function (to end point)		
C.	emergency brake	Check mech. /electrical.		
D.	controller, battery	Check for leaks, connection		
E.	battery voltage	Measure voltage		
F.	manual switch	Check electrical. function		
G.	Battery charger	Visual check, plug connection		
H.	cord connection	Check for damage		

** The plain bearings must be replaced once a year / applicable is the assembly instruction: GB-0213153

Maintenance Check / Accessories (All chairs)

P	Article	Scope of work	Remarks	Finding*
1.	bucket, cover	Damage, wear		
2.	Accessories slings	Damage, wear		

* Findings: I=inspected; E=exchanged; R=repaired, i.o. = in order; n.i.o. = not in order

The following parts were replaced: (Use only original parts from the manufacturer)

Qty.	Article description

Maintenance results / summary

Next maintenance: _____

Visual check	<input type="checkbox"/> i.O. <input type="checkbox"/> n.i.O	Function check	<input type="checkbox"/> i.O. <input type="checkbox"/> n.i.O	Passed	<input type="checkbox"/> yes <input type="checkbox"/> no
Cleaning carried out	<input type="checkbox"/> yes <input type="checkbox"/> no	Disposal carried out	<input type="checkbox"/> yes <input type="checkbox"/> no		

Date

Signature/maintenance company

Signature/customer

Maintenance overview



Product information/Multifunctional wheel chair: Phoenix -H/-E (medical product class I) REB02.11.151-18-09

Product			
Serial no.		Year manuf.	Use start
Manufacturer			
User			
Location of use		Inventory no.	

1st Maintenance Date	Maintenance company	Report	Signature

Remarks:

2nd Maintenance Date	Maintenance company	Report	Signature

Remarks:

3rd Maintenance Date	Maintenance company	Report	Signature

Remarks:

4th Maintenance Date	Maintenance company	Report	Signature

Remarks:

5th Maintenance Date	Maintenance company	Report	Signature

Remarks:



Nr.: 02.13.153/2018-02-A01



REBOTEC® Rehabilitationsmittel GmbH

D-49610 Quakenbrück, Artlandstr. 57-59

Telefon : 05431/9416-0

Telefax : 05431/9416-66

<http://www.rebotec.de>

E-Mail: info@rebotec.de

Assembly instruction

Maintenance kit

Bearing replacement

Ref.-no.: 450.00.90

Multifunction Wheelchair „Phoenix“

Ref.-no.: 350.xx/351.xx/352.xx



Wichtiger Hinweis!

Read the instructions before maintenance. Observe the maintenance instructions in the user instructions of the device.

General information

These installation instructions contain information and information on the safe and proper installation (**Step 1 to Step 6**) of the maintenance kit for multifunction care wheelchairs.

Only use original spare parts from REBOTEC for the maintenance of the product.

When carrying out the installation, please refer to the operating instructions of the respective product and observe the instructions for use, reuse, service life, warranty, care and maintenance.

Content of the maintenance kit:

No.	Articel	Article No.
1.	Cylinder head screw M8 x 35	851.58.35
2.	Cylinder head screw M6 x 10	850.56.10
3.	Washer M8	856.52.38
4.	Washer M6	856.54.06
5.	Sleeve 10 x 15	450.00.53
6.	Sleeve bearing bushing 10 x 13	450.00.55
7.	Allen key	858.00.05

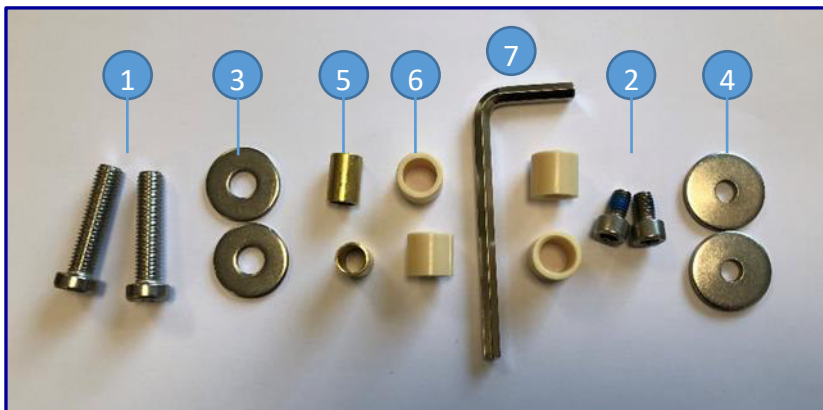

Step 1: Unlock the armrest

- 1 pull out the lock
- 2 swivel the armrest slightly backwards

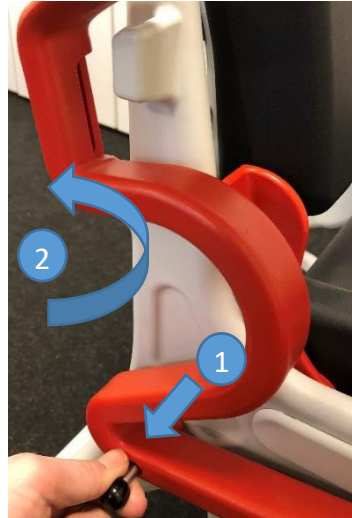

- 3 pull the armrest aside and swing it forward



- 4

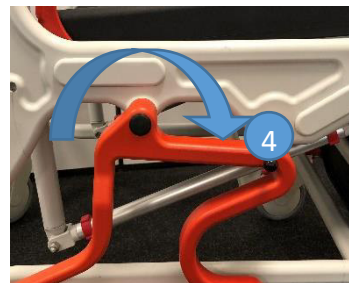

Step 2: Covers

- 1 remove protective covers on both sides
tilt the chair slightly backwards



Step 3: Rear bearings

- 2 loose the screws counterclockwise with the Allen key

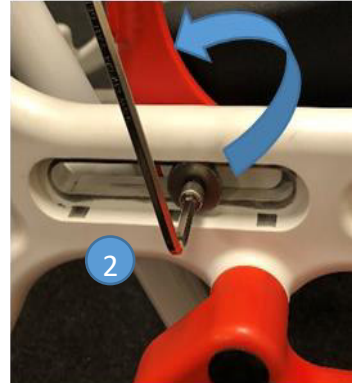

- 3 remove the bearing with the appropriate tool, moving the backrest forth and back could ease the procedure

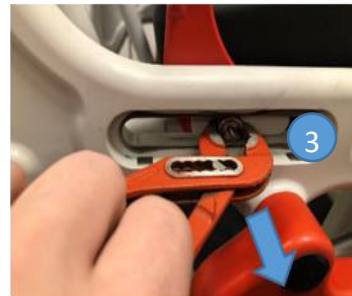

- 4 slide the sleeve onto the shaft



- 5 tighten screw with washer clockwise



Step 4: Front bearings

- 1 loose the screws counterclockwise with the Allen key
- 2 pull out the parts
- 3 plug spare parts together (brass and synthetic sleeve)

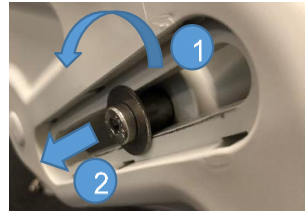

- 1
- 2 tighten screw with washer clockwise

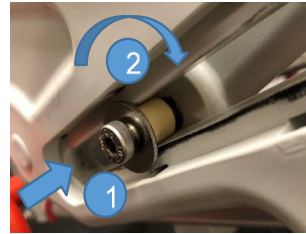

Step 5: Review

Check the ease of movement by tilting the chair, if necessary make adjustments, see model-based user instructions BA (9.5)

Step 6: Set-up use condition

Press the protective covers firmly into the frame until they click into place.

Swing the armrest back (reverse order to **Step 1**)



